



CELTIC

MINI SCONCES WALL

location:
DAMP

SPECIFICATIONS:

DESCRIPTION

Wall-mounted sconce featuring handcrafted glass.

LAMPING

Standard: 60W E26 base A19, 120V, suitable for dimming, lamp not included. Dimmable with standard incandescent dimmer (not included).

LED: 9W Replaceable source, 120V, dimmable, 90+ CRI, 3000°K CCT, 800 lumens, 30,000 hours, lamp included. (For Opal/Clear only).

LED Filament: 8W Replaceable A19 LED Filament lamp, 120V, dimmable, 90+ CRI, 3000°K CCT, 800 lumens, 30,000 hours, lamp included (For Bubble only).

DIFFUSER

Shade shall be handcrafted glass of various decors.

6" L x 4.75" D x 7.65" H

CONSTRUCTION

Fixture utilizes die-cast arm assembly and stamped steel canopy (4.75" H), with plated metal finish.

METAL FINISH

Fixture shall be finished in Black, Chrome or Satin Nickel.

MOUNTING

Installs directly to a 4" octagonal outlet box. Orient upward or downward, wall-mount only.

LABELS

UL or ETL Listed. Suitable for Damp Locations (interior use only).



CELTIC SHOWN IN OPAL GLOSSY/CLEAR (CELTICCL) IN CHROME FINISH

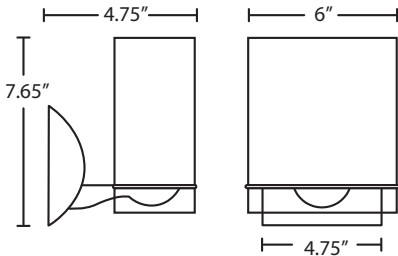

CELTICBB
BUBBLE

ORDERING:

FIXTURE	GLASS OPTIONS	LAMPING OPTIONS	METAL FINISH
1WZ Sconce	CELTICBB Bubble	(blank) 60W A19	BK Black
	CELTICCL Opal/Clear	LED 9W LED (For Opal/Clear)	CR Chrome
		EDIL 8W LED Filament (For Bubble)	SN Satin Nickel

Ex. 1WZ-CELTICCL-SN
Celtic Mini Sconce w/ Clear Glass,
Satin Nickel Finish



Project Information:

All dimensions provided are nominal.
Allowance must be made for dimensional tolerance in handcrafted glasses.

REV 10/24