



# SOLO

120V PENDANTS

location:  
**DAMP**

## SPECIFICATIONS:

### DESCRIPTION

Rope-hung pendant with inner SVT Cord, medium base socket and Black Aluminum socket cover.

### LAMPING

**Standard:** 60W G40 Medium-based 120V, lamp not included. Dimmable with standard incandescent dimmer (not included).

**EDI:** 60W G63 Grand Edison Filament Medium-based, lamp included.

**LED Filament:** 4W G40 Replaceable LED Filament lamp, 120V, dimmable, lamp included.

### SUSPENSION

**Rope-hung:** 6'-0" long and 2" dia natural hemp rope, field-cutable with inner SVT Cord. Also available as 3-light fixture.

### MOUNTING

Black flat canopy with support hook, installs directly to a 4" octagonal ceiling box. Suitable for sloped ceilings.

### LABELS

UL or ETL Listed. Suitable for Damp Locations (interior use only).



SOLO SHOWN WITH G63 GRAND EDISON (EDI) & G40

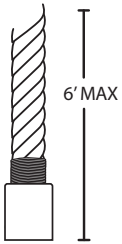

### 3JW 3 LIGHT LARGE ROUND CANOPY

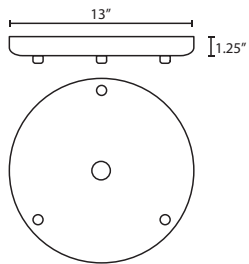

- Suitable for sloped ceilings
- Black finish



Swag T104-BK



Canopy detail

## ORDERING:

CONNECTION	SHADE OPTIONS	LAMP OPTIONS	METAL FINISH	OPTIONS
Pendant Fixtures	<b>SOLO</b> Rope	(blank) 60W G40 Incan	<b>BK</b> Black	<b>L</b> 15' Rope
<b>1JT</b> Flat Canopy	6' Length	<b>EDI</b> 60W Grand Edison G63		
<b>3JW</b> 3-Lt. 13" Round		<b>EDIL</b> 4W LED Filament		

**Ex. 1JT-SOLO-BK**  
Solo Pendant, Black Finish

**Project Information:**

All dimensions provided are nominal. Allowance must be made for dimensional tolerance in handcrafted glasses.

REV 5/22