



PAHU 4

MINI SCONCES WALL

location:
DAMP

SPECIFICATIONS:

DESCRIPTION

Wall-mounted sconce featuring one handcrafted glass.

LAMPING

Standard: 40W G9 Bi-pin base, 120V, lamp included. Suitable for use in an open fixture. Dimmable with standard incandescent dimmer (not included).

LED: 5W Replaceable source, 120V, dimmable, 90+ CRI, 3000° K CCT, 450 lumens, 25,000 hours, lamp included.

DIFFUSER

Shade shall be handcrafted double glass of various decors.
Outer diameter of 4.0" and height of 7.0"

CONSTRUCTION

Fixture utilizes metal arm assembly with stamped steel canopy and faceplate (5" Circle or Square), with plated finish.

METAL FINISH

Fixture shall be finished in Bronze, Chrome or Satin Nickel.

MOUNTING

Installs directly to a 4" octagonal outlet box. Wall-mount only.
Designed for uplighting, but may also be oriented downward.

LABELS

UL or ETL Listed. Suitable for Damp Locations (interior use only).



PAHU 4 SHOWN IN TRANS. ARMAGNAC/OPAL (G44007) &
TRANS. AMETHYST/OPAL (A44007)

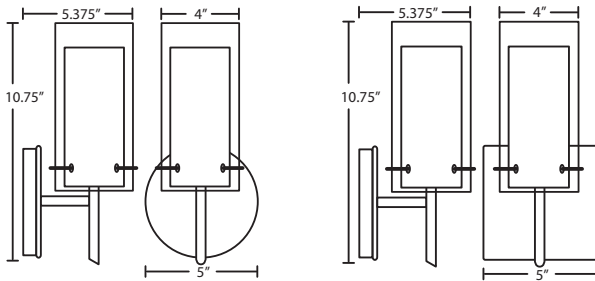

ORDERING:

FIXTURE	GLASS OPTIONS	METAL FINISH	METAL FINISH	OPTIONS
1SW Sconce	A44007 Trans. Amethyst/Opal C44007 Clear/Opal G44007 Trans. Armagnac/Opal L44007 Trans. Olive/Opal S44007 Trans. Smoke/Opal	(blank) 40W G9 Socket LED 5W LED 120V, dimmable	BR Bronze CR Chrome SN Satin Nickel	SQ Square Canopy

Ex. 1SW-G44007-SN

Pahu 4 Mini Sconce w/ Trans. Armagnac/Opal Glass,
Satin Nickel Finish



Project Information:

All dimensions provided are nominal.
Allowance must be made for dimensional tolerance in handcrafted glasses.

REV 10/24